

NOTES:

- 1. PLAN SHOWN BASED ON STRUCTURES SKETCH NO. "ST-10-004_B" PROVIDED TO WSP ON 20-07-2021. (STRUCTURAL 75% PRELIMINARY DESIGN ISSUE).

LEGEND:

EXISTING:

CADASTRAL BOUNDARY

PROPOSED:

WALKWAY

-300mm STEP IN LEVEL OF TOP OF SLAB RELATIVE TO THE PROPOSED LOWER GROUND FFL

-400mm STEP IN LEVEL OF TOP OF SLAB RELATIVE TO THE PROPOSED LOWER GROUND FFL

SUBFLOOR SLAB

LIFT PIT

LIFT PIT MOVEMENT ALLOWANCE

VIE TANK/WATER TANK RAFT FOUNDATION

LINK BRIDGE FOUNDATION

SITE BOUNDARY

PROPOSED SUBGRADE LEVELS

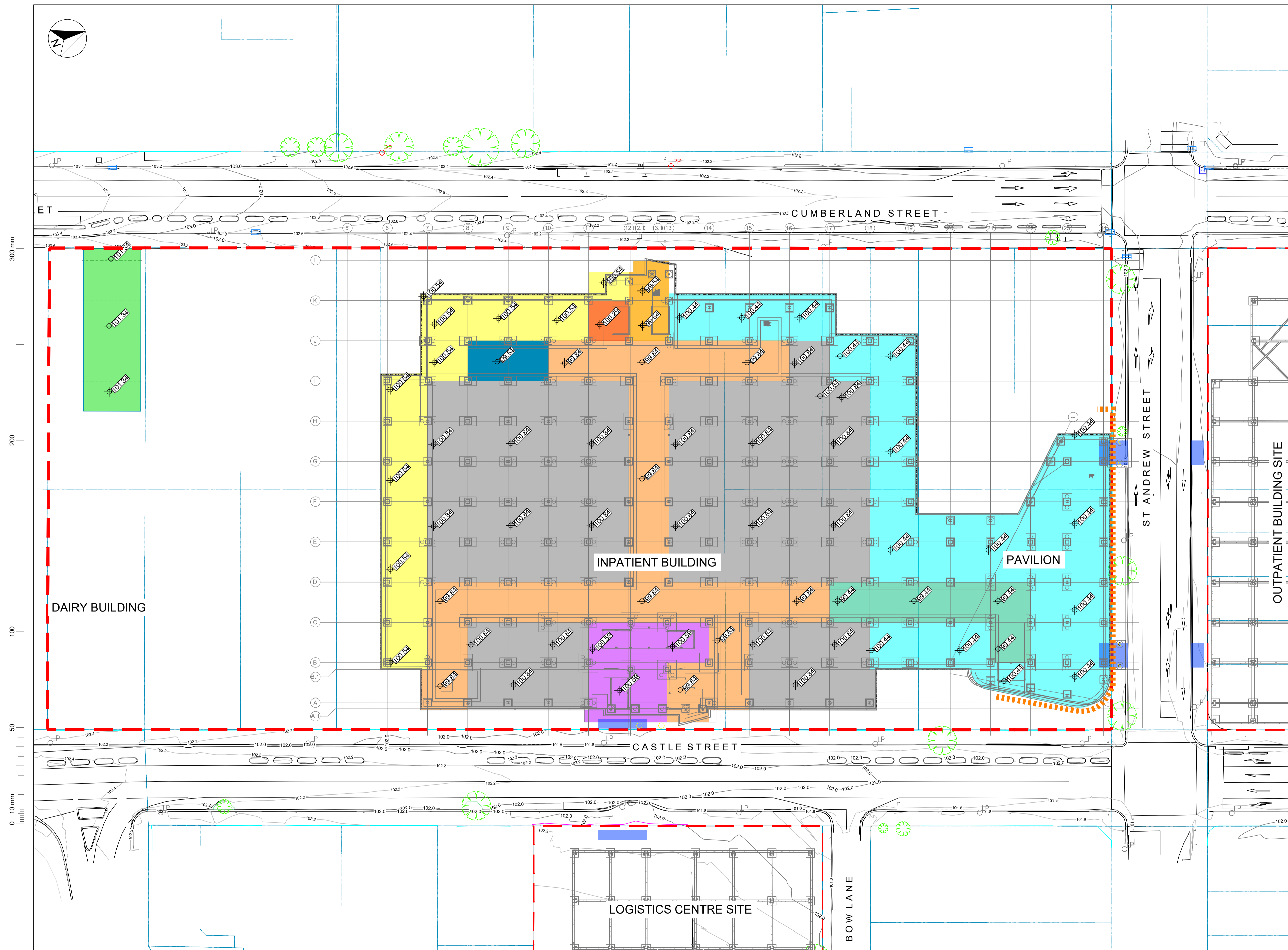

300 mm
200
100
50
0 10 mm

REVISION	AMENDMENT	APPROVED	DATE
A	ENABLING WORKS CONSENT - CLIENT REVIEW	R.N	2021-07-05
B	ENABLING WORKS CONSENT - ISSUE	R.N	2021-07-23
C	ENABLING WORKS - FINAL ISSUE	R.N	2021-08-11



wsp
Christchurch Office
+64 3 363 5400
PO Box 1482
Christchurch 8140
New Zealand

CIVIL

SCALES	DESIGNED	APPROVED
1:400 @ A1; 1:800 @ A3	L. THOMAS	R. NOOAPII

ORIGINAL SIZE A1

ENABLING WORKS CONSENT

PROJECT					
MINISTRY OF HEALTH NEW DUNEDIN HOSPITAL STAGE 2 INPATIENT BUILDING					
TITLE					
PROPOSED SUBGRADE SURFACE OVERVIEW PLAN					
OPUS PROJECT NO.		PROJ-ORIG-VOL-LVL-TYPE	SHEET NO.	SUITABILITY	REVISION
6-DP450.00		WSP-DWD-0111	C-80-0351_EWC		C