

- NOTES:
- 1) Adjacent Property Ownership information from Quickmap Custom Software Ltd.
 - 2) Legend:
 - = Project Land
 - = Adjacent Parcels & Parcels Touching Project Land
 - = Road Parcel
 - = Primary Parcels
 - 3) Abbreviations:
 - DP= Deposited Plan
 - JOAL = Jointly Owned Access Lot
 - NA = North Auckland

PREPARED FOR

Karaka North Village Ltd

ADJACENT PROPERTY OWNERSHIP INFORMATION
55 & 69 DYKE ROAD
KARAKA

Project Site:
 Lots 1 & 2 DP 536479

SCALE	DATE
1:9000 (A3)	March 2021
SURVEYED	DRAWN MvK



Yeomans Survey Solutions Limited
 Unit 1C Level 1 29 Karaka St Newton
 PO Box 7184 Auckland
 p:(09) 309 0880 f:(09) 369 9210
 e: info@yeomanssurvey.co.nz

FILE	Drawing
8284/L	1
	of 2 Drawings

R:\Jobs\8284-KARAKA NORTH VILLAGE LTD-LINWOOD ROAD-KARAKA\12D\Adjacent Land Identification Adjacent Land Identification Thu Mar 17 12:01:44 2022

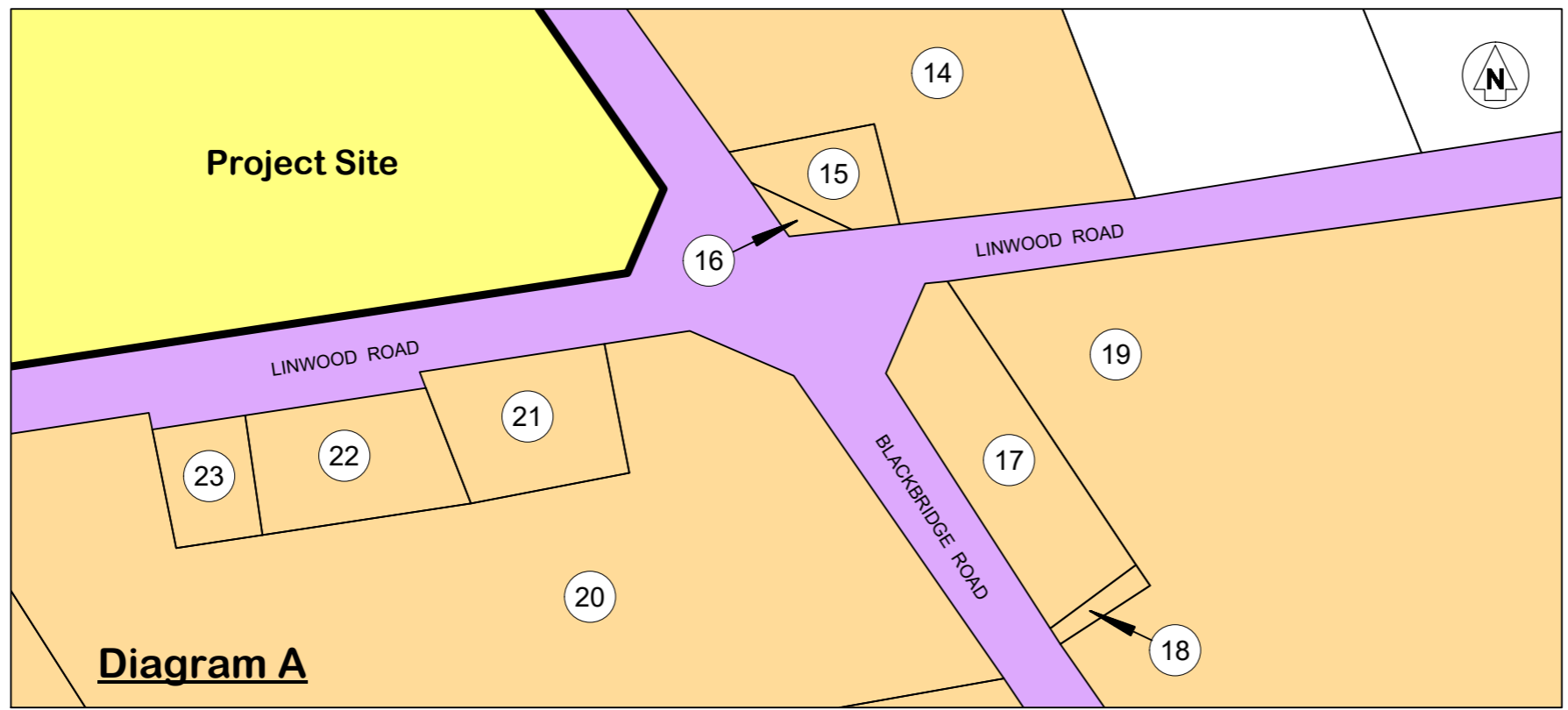

Diagram A

NOTES:

1) Adjacent Property Ownership information from Quickmap Custom Software Ltd.

2) Legend:

- = Project Land
- = Adjacent Parcels & Parcels Touching Project Land
- = Road Parcel
- = Primary Parcels

3) Abbreviations:

- DP= Deposited Plan
- JOAL = Jointly Owned Access Lot
- NA = North Auckland

Adjacent Property Ownership Information - Karaka North Village Ltd				
Shown	Legal Description	Land Owner	Record of Title	Area (By Title) (Ha.)
1	Lot 2 DP 409182	[REDACTED]	433651	39.6670
2	Lot 1 DP 409182	[REDACTED]	433650	4.4182
3	Lot 1 DP 53747	[REDACTED]	NA16B/598	2.8126
4	Lot 1 DP 455617	[REDACTED]	586657	0.6934
5	Lot 1 DP 111321	[REDACTED]	NA62C/1116	0.6830
6	Lot 2 DP 111321	[REDACTED]	NA62D/162	12.8070
7	Lot 5 DP 115882	[REDACTED]	NA65D/738	5.1770
8	Lot 1 DP 480550	[REDACTED]	671763	0.3136
9	Lot 2 DP 480550	[REDACTED]	671764	0.2817
10	Lot 4 DP 480550	[REDACTED]	671766	3.4581
11	Lot 3 DP 480550	[REDACTED]	671765	0.6510
12	Lot 1 DP 342032 (JOAL)	[REDACTED]	172805	0.2923
13	Lot 2 DP 123078	[REDACTED]	NA71C/525	1.0879
14	Lot 1 DP 123078	[REDACTED]	NA71C/524	2.4696
15	Lot 1 DP 40523	[REDACTED]	NA1072/118	0.0814
16	Part Lot 2 DP 9304 (SO 30377)	[REDACTED]	NA1072/119	0.0182
17	Part Lot 18 DP 9285	[REDACTED]	NA15A/1069	0.3741
18	Lot 1 DP 59691	[REDACTED]	NA15A/1069	0.0245
19	Lot 2 DP 85956	[REDACTED]	414819	4.0468
20	Lot 1 DP 204608	[REDACTED]	NA132C/35	2.5340
21	Lot 2 DP 109611	[REDACTED]	NA61C/945	0.2137
22	Lot 2 DP 144995	[REDACTED]	NA86A/151	0.2174
23	Lot 1 DP 144995	[REDACTED]	NA86A/150	0.1000
24	Lot 2 DP 204608	[REDACTED]	NA132C/36	27.0800
25	Lot 1 DP 193490	[REDACTED]	NA122B/909	2.0008
26	Lot 3 DP 159159	[REDACTED]	NA95D/30	5.1718

Adjacent Property Ownership Information - Karaka North Village Ltd Continued				
Shown	Legal Description	Land Owner	Record of Title	Area (By Title) (ha.)
27	Lot 11 DP 159159 (JOAL)	See 27A to 27G below		0.5034
27A	Lot 2 DP 193490	[REDACTED]	NA122B/910	8.2953
27B	Lot 1 DP 543375	[REDACTED]	918082	0.6710
27C	Lot 2 DP 543375	[REDACTED]	918083	2.1500
27D	Lot 6 DP 159159	[REDACTED]	NA95D/33	5.2092
27E	Lot 7 DP 159159	[REDACTED]	NA95D/34	5.4033
27F	Lot 8 DP 159159	[REDACTED]	NA95D/35	6.4517
27G	Lot 9 DP 159159	[REDACTED]	NA95D/36	4.9617
28	Lot 2 DP 159159	[REDACTED]	NA95D/29	5.8340
29	Lot 1 DP 159159	[REDACTED]	NA95D/28	4.3766
30	Lot 12 DP 159159	[REDACTED]	NA95D/38	2.3460
31	Part Lot 1 DP 56809	[REDACTED]	NA77A/359	8.4438
32	Part Allotment 20 Parish of Karaka	[REDACTED]	NA529/28 (Ltd)	0.2276
33	Lot 1 DP 200865	[REDACTED]	NA129C/771	27.2100
34	Lot 2 DP 454752	[REDACTED]	584277	3.9813
35	Lot 1 DP 454752	[REDACTED]	584276	38.7130
36	Lot 19 DP 153672	[REDACTED]	NA133C/83	1.9000
37	Lot 21 DP 154764	[REDACTED]	NA92D/347	0.7425
38	Lot 22 DP 158573	[REDACTED]	NA96B/917	0.0130
39	Lot 13 DP 159159	[REDACTED]	NA95D/39	0.0028
40	Lot 14 DP 159159	[REDACTED]	NA95D/40	0.0054

PREPARED FOR

Karaka North Village Ltd

ADJACENT PROPERTY OWNERSHIP INFORMATION
55 & 69 DYKE ROAD
KARAKA

Project Site:
 Lots 1 & 2 DP 536479

SCALE **1:2000 (A3)** DATE **March 2021**
 SURVEYED DRAWN **MvK**



Yeomans Survey Solutions Limited
 Unit 1C Level 1 29 Karaka St Newton
 PO Box 7184 Auckland
 p:(09) 309 0880 f:(09) 369 9210
 e: info@yeomanssurvey.co.nz

FILE **8284/L** Drawing **2**
 of 2 Drawings